

TOTAL AREA = 10300 S.F. ±

FRONT STREET  
(SEE NOTE 3)

KENNEBEC RIVER

74± ALONG HIGH WATER LINE  
OBSERVED AT 10:00 AM ON 12-02-2014

N/W  
HARWOOD PROPERTIES, LLC  
BOOK 1102, PAGE 59, 01-16-2014

N/W  
JANET MCK MERRILL  
JOHN R. MERRILL  
BOOK 1001, PAGE 95, 03-18-2011

- LEGEND**
- = 5/8" IRON REBAR WITH 10' CAP #107 SET
  - ⊙ = LIGHT POLE
  - ⊙ = UTILITY POLE
  - = OVERHEAD UTILITIES
  - = KENNEBEC COUNTY REGISTRY OF DEEDS
  - = UNDERGROUND SEWER LINE
  - = BRICK BUILDING STRUCTURE
  - = WOODEN BUILDING STRUCTURE

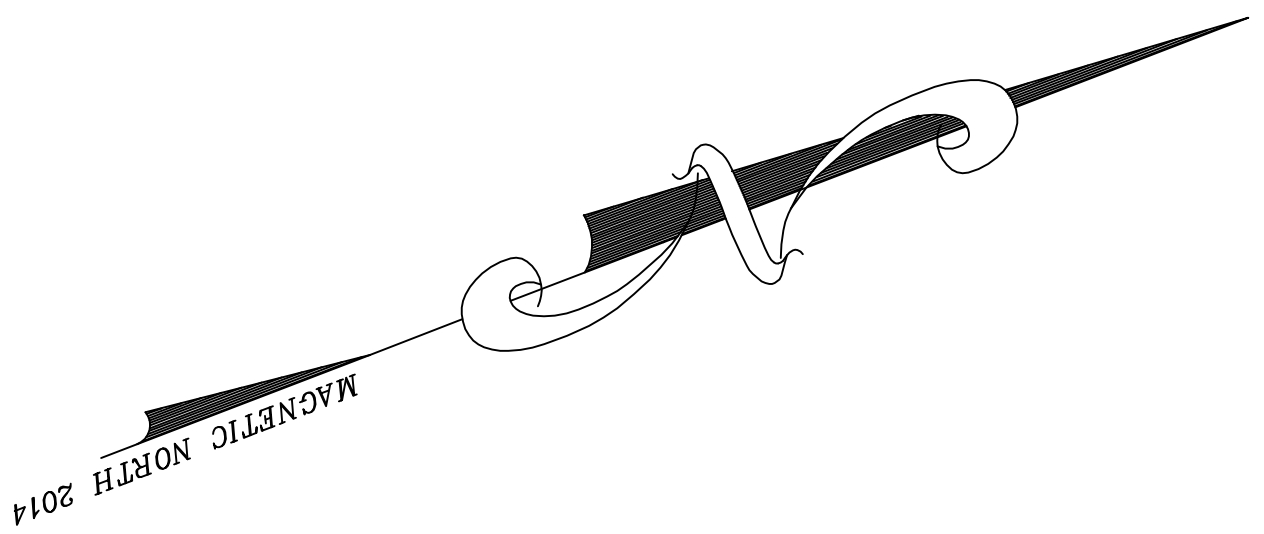

**NOTES**

- 1) OWNER OF RECORD TERRY L. BERRY SOURCE DEED BOOK 5763, PAGE 348, DATED 07-01-2008
- 2) THE RIGHT OF WAY FOR WATER STREET IS BASED ON PLAN REFERENCE 1 HOLDING THE FACE OF THE EXISTING BRICK BUILDINGS.
- 3) THE TOWN OF HALLOWELL DOES NOT HAVE A LAYOUT FOR FRONT STREET BUT THEY DO MAINTAIN AND CLAIM TO HAVE RIGHTS OVER THE PORTION NORTHERLY OF CENTRAL STREET. THE LIMITS OF FRONT STREET AS SHOWN HEREON ARE BASED ON PLAN REFERENCE 2 & 3 EVEN THOUGH NO EXCEPTIONS FOR IT COULD BE FOUND IN THE CHAIN OF TITLE.

**PLAN REFERENCE**

- 1) MAINE STATE HIGHWAY COMMISSION RIGHT OF WAY MAP STATE HIGHWAY T, HALLOWELL, KENNEBEC COUNTY, FERRIS AND PROJECT NO. 301-2(3) DATED 07/02/92, FILE NO. 6-101.
- 2) PLAN OF NO. 190-134-134 WATER STREET, HALLOWELL, MAINE, DATED MARCH 14, 1979 BY W. W. HILL, ENG. RECORDED IN THE KARD PLAN FILE C-81046.
- 3) SKETCH OF LOTS NO. 124 TO 134 WATER STREET, HALLOWELL, MAINE, DATED JANUARY 14, 1946 BY W. W. HILL, ENG. RECORDED IN THE KARD PLAN BOOK IS PAGE 1.

**TOPOGRAPHY NOTES**

- 1) ELEVATIONS SHOWN HEREON ARE BASED ON A BRASS PINK LOCATED ON THE SOUTH WALL OF THE HALLOWELL POST OFFICE LABELED "1" 197' ELEVATION = 5184 MMW 88 DATUM.
- 2) CONTROL LINES ARE AT 1' (FOOT) INTERVALS.
- 3) NO INVESTIGATION OF SUBSURFACE FEATURES HAS BEEN MADE. A UTILITY LINE LOCATION CONSULTANT SHOULD BE CALLED BEFORE ANY EXCAVATION IS PERFORMED ON THIS SITE.
- 4) THE 100 YEAR FLOOD ELEVATION IN THIS AREA IS AT 28.0 FEET.

TO THE BEST OF MY KNOWLEDGE THIS SURVEY COMPLIES WITH THE MAINE STATE BOARD OF LICENSED PROFESSIONAL LAND SURVEYORS STANDARDS OF PRACTICE. 1/2 MESA 56 (1910) EFFECTIVE DATE APRIL 1, 2001, NO SURVEY REPORT OTHER THAN THE INFORMATION SHOWN ON THIS PLAN.

THIS PLAN IS PRELIMINARY WITHOUT AN EMBOSSED SEAL.  
*Morin Land Surveying*  
SHAWN M. TYLER, P.L.S. #599



KENNEBEC 55 REGISTRY OF DEEDS  
RECORDED  
FILE NO. \_\_\_\_\_ REGISTER

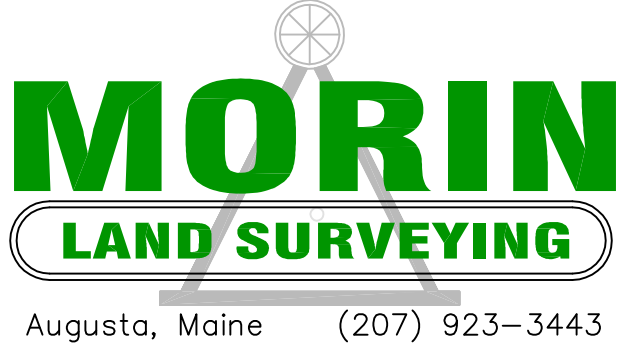

BS/TOP0

PROJECT / CLIENT: <b>TERRY BERRY</b> 106 WATER STREET HALLOWELL, MAINE 04347	SHEET TITLE: <b>TOPOGRAPHIC AND BOUNDARY SURVEY</b> OF 116 WATER STREET
PROJECT LOCATION: <b>116 WATER STREET</b>	SCALE: <b>1" = 10'</b>
TOWN: <b>HALLOWELL</b> COUNTY: <b>KENNEBEC</b> STATE: <b>MAINE</b>	DATE: <b>12-01-2014</b>

FILE NO. H140K PLD BOOK NO. 97 PLAN NO. 592	1	ADDED 1 FOOT CONTOUR LINES AND TOPOGRAPHY NOTES	02-16-2015